

2
15 KEY PLAN
N.T.S.

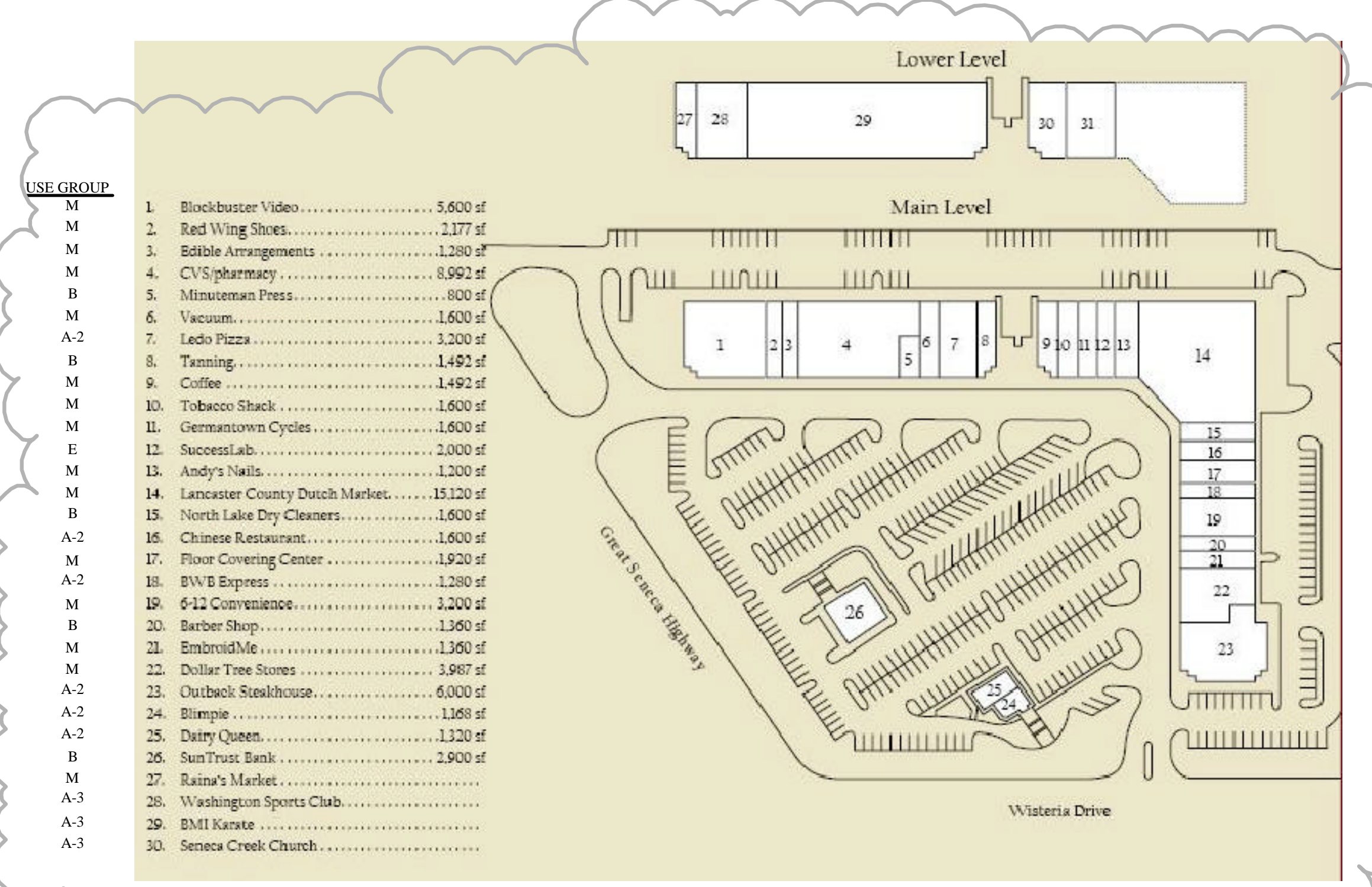

3
15 EXISTING TENANT LAYOUT
N.T.S.

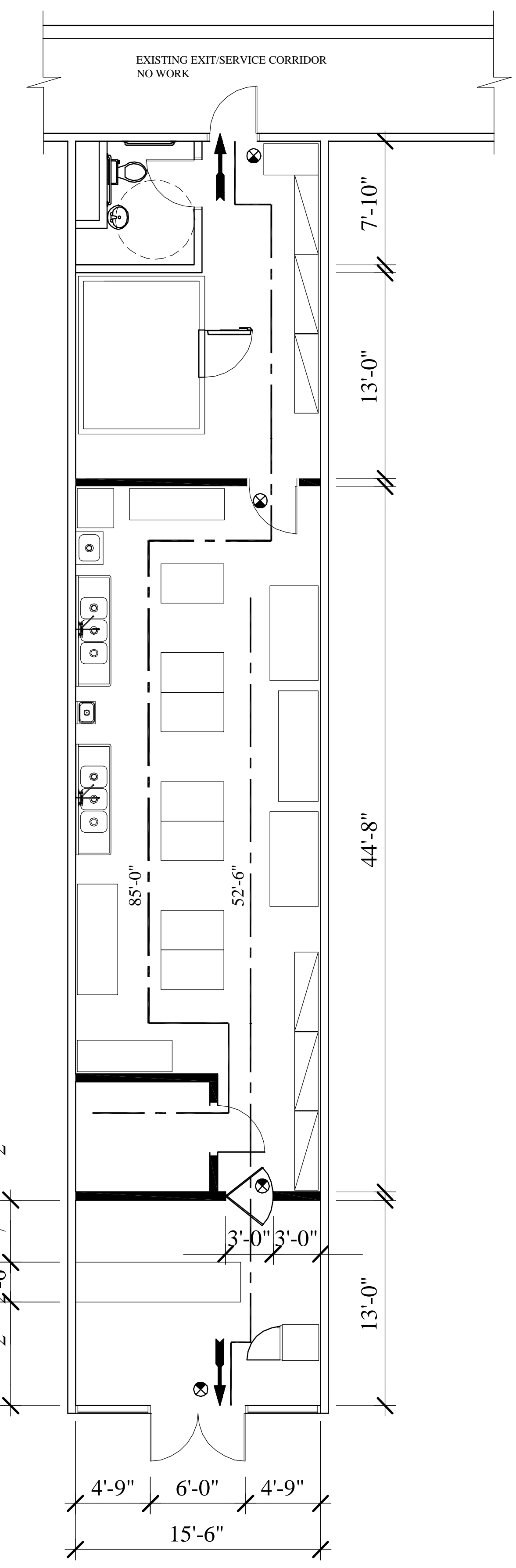

1
15 LIFE SAFETY PLAN
3/32" = 1'-0"

CODE ANALYSIS:

SUBMITTER:
EXLIBER GENERAL CONTRACTING
4815 HIGH RIDGE RD
HAYMARKET, VIRGINIA 20169

APPLICABLE BUILDING CODES:

- 2003 MONTGOMERY COUNTY CODE
- 2003 INTERNATIONAL BUILDING CODE
- 2003 INTERNATIONAL MECHANICAL CODE
- 2003 INTERNATIONAL PLUMBING CODE
- 2002 NATIONAL ELECTRIC CODE
- 2003 INTERNATIONAL FIRE CODE

BASE BUILDING USE GROUP:
M MERCHANTILE MIXED USE PER ORIGINAL PERMIT DRAWINGS 1988.

TENANT AREA:
12619K EXISTING 1250 SQ.FT. PROPOSED 1250 SQ.FT.

OCCUPANCY LOAD:
1250 SQ. FT. PER CODE 30 GROSS PROPOSED 42 OCCUPANTS

USE GROUP:
BUSINESS M MERCHANTILE

CONSTRUCTION TYPE:
NO. OF FLOORS: 2
FIRE SUPPRESSION: FULLY SPRINKLERED

SEPERATIONS:
TENANT WALL UL 425 EXIST. BETWEEN M UNITS: 0 HOUR (EXIST.) / 1 HOUR (PROVIDED)

STRUCTURAL FRAME: 0 HOUR (EXIST.) / 0 HOUR (PROVIDED)

BEARING WALLS:
EXTERIOR: 0 HOUR (EXIST.) / 2 HOURS U905 (PROVIDED)
INTERIOR: 0 HOUR (EXIST.) / 0 HOUR (PROVIDED)

NONBEARING WALLS:
EXTERIOR: 0 HOUR (EXIST.) / 0 HOUR (PROVIDED)
INTERIOR: 0 HOUR (EXIST.) / 0 HOUR (PROVIDED)

FLOOR CONSTRUCTION: 0 HOUR (EXIST.) / 0 HOUR (PROVIDED)

ROOF CONSTRUCTION: 0 HOUR (EXIST.) / 0 HOUR (PROVIDED)

FIRE WALLS: 0 HOUR (EXIST.) / 3 HOURS U904 (PROVIDED)

FIRE WALL SEPERATION:
TENANT SEPERATIONS CORRIDORS: 1 HOUR WP1200 (PROVIDED)

FIRE ENCLOSURES AT EXITS, EXIT HALLWAYS, AND STAIRWAYS: 2 HOURS WP1111 (PROVIDED)

SHAFTS AND ELEVATOR HALLWAYS: 2 HOURS WP1111 (PROVIDED)

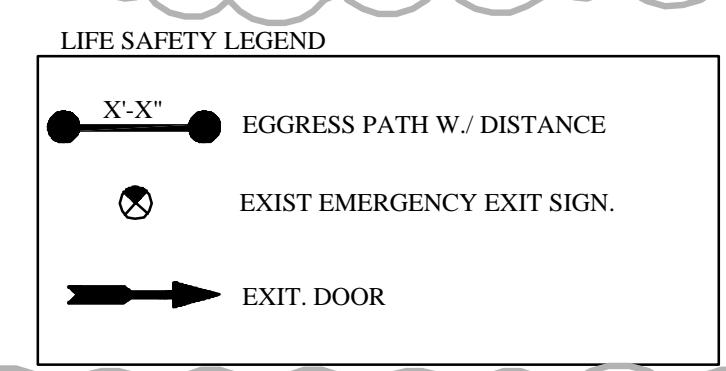

IBC-2003 AND NFPA 101-2003	EXISTING BLDG.	EXISTING SPACE	PROPOSED SPACE CHANGES & ALTER.
IBC-2003 BLDG. USE GROUP CLASSIFICATIONS:	A-2, A-3, B, M	B	M
NFPA101 OCCUPANCY CLASSIFICATION(S)	ASSEMBLY, BUSINESS, MERCANTILE	BUSINESS	MERCANTILE
SEPERATED MIXED USE PER IBC/NFPA (Y/N)	Y	Y	Y
CONSTRUCTION TYPE PER IBC-2000	IIB	IIB	IIB
NUMBER OF STORIES ABOVE GRADE:	1	1	1
HIGH RISE: (Y/N)	N	N	N
FIRE ALARM SYSTEM: (Y/N)	N	N	N
FULLY SPRINKLERED & MONITORED (Y/N)	Y	Y	Y
TOTAL BUILDING AREA (SF)	80,307	N/A	N/A
COVERD MALL (Y/N)	N	N	N
FLOOR AREA OF RENOVATION/TENANT SPACE (SF)	N/A	1,250	1,250



636 WOOD STREET
HERNDON, VA 20170
DIRECT: 703.819.9481
FAX: 703.935.3098
michaelw@mwarehouse.biz

12619K Wisteria Dr
Germantown, MD 20874
LIFE SAFETY PLAN

Edible Arrangements
Interior Fitout

SEAL:

REVISIONS:
Permit Set 08.16.07
Permit Comments 09.11.07
Permit Comments 09.18.07

DRAWN BY: CHH

CHECKED BY: MSW

SCALE: AS NOTED

DATE: 08.16.07

PROJECT NO. 07.110

DRAWING NO.

LS